

Suomi Iron Prospect

(as copied from "Iron Formations of Ontario" authored by Roman Shklanka, 1968)

Class: Iron Formation, Superior type, oxide facies

Location: Near NE corner of Whitefish Lake.

Reference: ODM Map 2065.

Description: Gently dipping, Gunflint iron formation composed of magnetite, jasper, silica and slate capped by 60 to 100 feet of Keweenawan diabase.

Economic Features: Drilling intersected 73 to 380 feet of iron formation, including a 75-foot section of magnetite-jasper.

Previous sampling from Silver Bluff and the east face of Divide Ridge which assayed 26.4%, 30.4% and 32.3% Fe gave concentrates of 43.4%, 53.6% and 50.4% Fe at -200 M with weight recovery of 39.6%, 47.2% and 27.1% Fe.

History: 1958(?) 5 d.d. holes for 1,306 feet by Seaway Iron Mines Ltd.

References: ODM map 2065, 1960j.

ODM, 1960, Volume LXIX, pt.7.

Assessment files, Port Arthur.

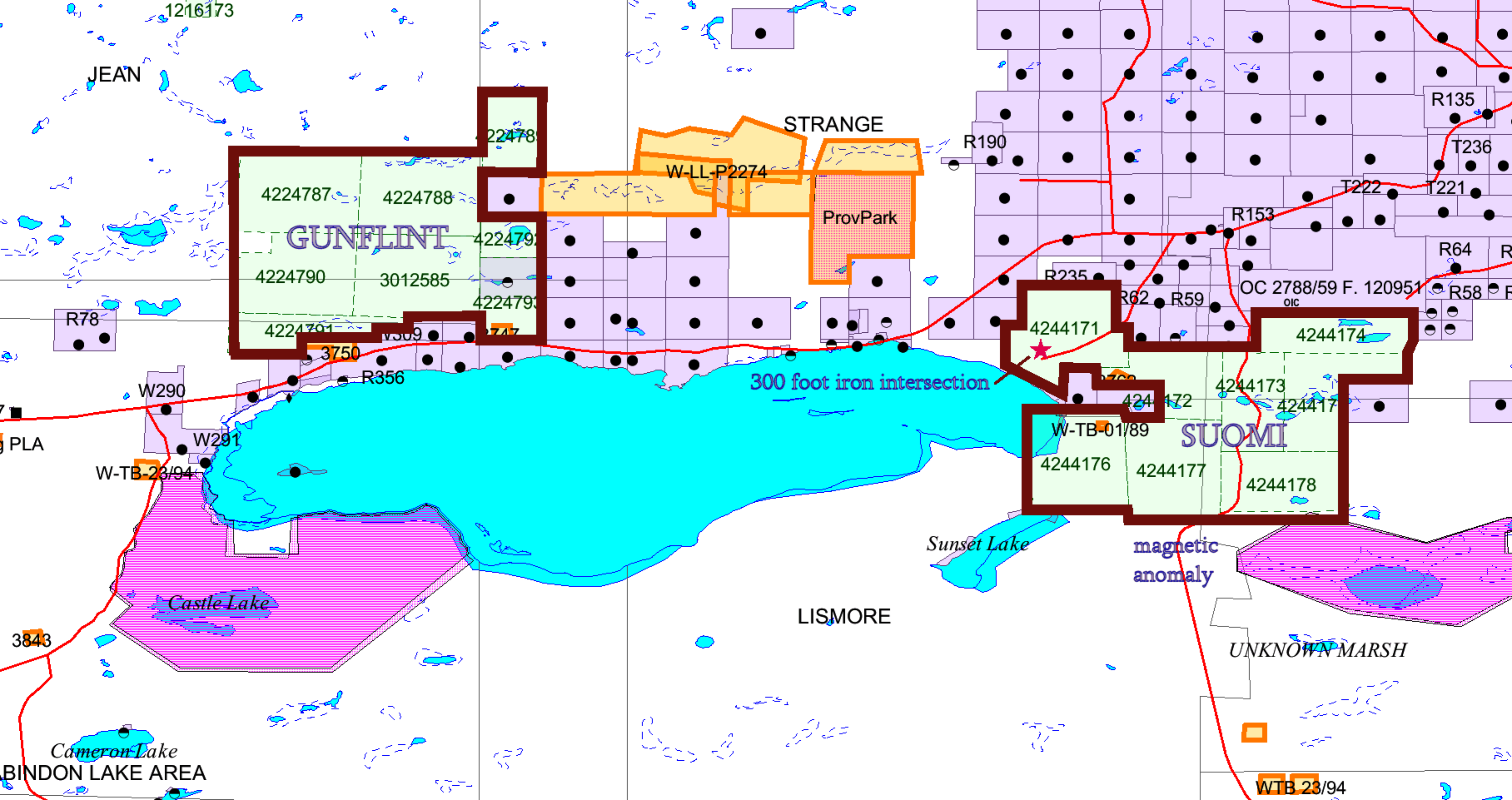

JEAN

1216173

STRANGE

GUNFLINT

ProvPark

SUOMI

LISMORE

UNKNOWN MARSH

300 foot iron intersection

magnetic anomaly

Castle Lake

Sunset Lake

Cameron Lake

BINDON LAKE AREA

4224787

4224788

4224790

3012585

4224791

4224791

3750

3750

3747

W-LL-P2274

R190

R135

T236

T222

T221

R153

R64

R

OC 2788/59 F. 120951
oic

R58

R78

4244171

4244174

4244173

4244172

4244171

W-TB-01/89

4244176

4244177

4244178

W-TB-23/94

W290

R356

W291

PLA

3843

WTB 23/94

Monow
Lake

